



Series | Flat vacuum cups SF

Flat vacuum cups with long shaft – SFU-L

Flat vacuum cups with long shaft – SFU-L



Product notes

Flat vacuum cups for handling sensitive or uneven and slightly curved products. Long, slim design enables pipe mounting and low gimbal leveling for uneven product surfaces.

Advantage

- > Gentle handling of particularly sensitive products
- > Cost-effective replacement of worn seals

Technical data

Item no.	Model / Lip dimensions		Material / Color
122.006.002.*	SFU-L-6	1.5	NBR (sw), SI (tr)
122.010.005.*	SFU-L-10	1.5	NBR (sw), SI (tr), SI-LE (tr)
122.016.009.*	SFU-L-16	5	NBR (sw), SI (tr), NR (sw)
122.025.025.*	SFU-L-25	5	NBR (sw), SI (tr), NR (sw)

Accessories

Item no.	 Suitable fittings				
	M5-male	G1/8-male	G1/8-female	G1/4-male	G1/4-female
122.006.002.*	270.001	--	--	--	--
122.010.005.*	270.022	--	--	--	--
122.016.009.*	270.013	270.003	270.015	270.194	--
122.025.025.*	--	270.132	270.114	270.043	270.178

* Material code: NBR = 1, SI = 2, SI-LE = 2-LE (för Livsmedel/For food Handling), NR = 3



Dimensions

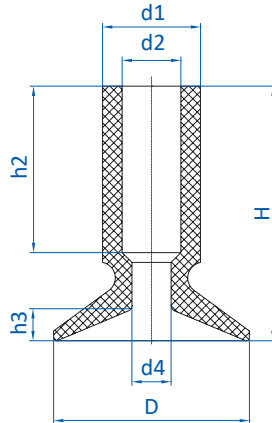

Item no.	∅ D [mm]	∅ d1 [mm]	∅ d2 [mm]	∅ d4 [mm]	H [mm]	h2 [mm]	h3 [mm]
122.006.002.*	6	4	2	1	12	8	1.3
122.010.005.*	10	5	3	2	13	8.5	1.6
122.016.009.*	16	8	4.8	2.5	20	13	3.8
122.025.025.*	25	12	8	4	30	18	5.5