

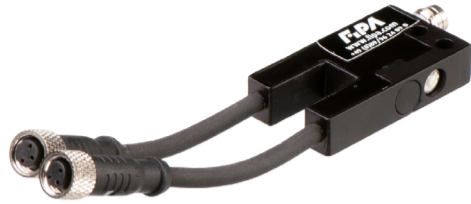

T-coupler bundlers with and/or logic



20.526

Product notes

- > T-coupler connects 2x M8-female with 1x M8-male
- > Interconnection of sensor signals on gripper systems
- > Please note for 20.525 and 20.525/NPN:
If more than five sensors need to be connected we recommend to use switchboxes such as GS01.006 instead of T-couplers

Technical data

Item no.	Electric connection	Operating voltage [VDC]	Protection class	Logic	Weight [g]
20.524	PNP/NPN	24	IP67	2x or	15
20.525	PNP	24	IP67	2x and	15
20.526	PNP	10 - 35	IP67	2x and/or	25

Application example



Dimensions

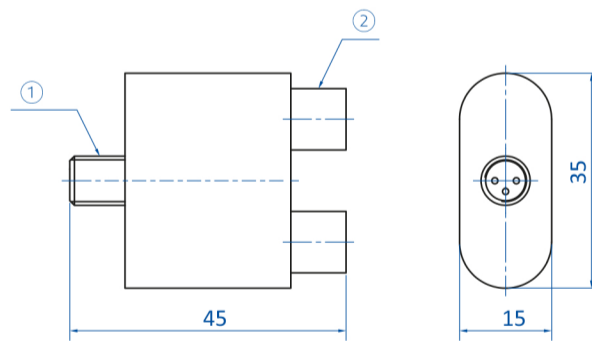

20.524 | 20.525

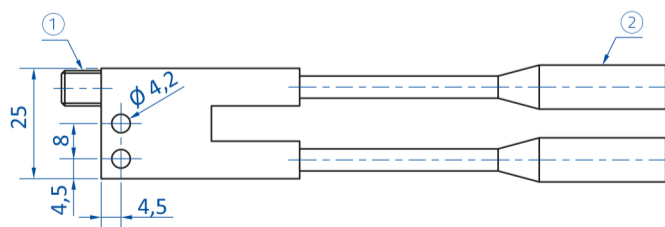
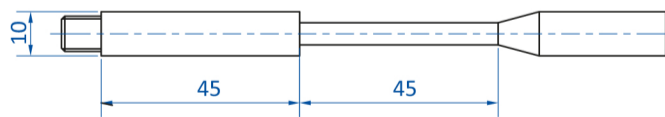

20.526

① = Plug, 3-pin M8x1 ② = Socket, 3-pin M8x1