







Flat vacuum cups with fully assembled fitting – SP-F



| Product description | Advantage |
|--|--|
| <p>Universal flat vacuum cups in even or supported design. Series with sensing valve prevents dropping of the product if individual vacuum cups in a system are not in contact with the product.</p> <p>Version: Complete with vacuum cup fitting and filter screen.</p> | <ul style="list-style-type: none"> > High suction force > Fast cycle times possible > Very resistant to wear (Tepuflex®) > Compatible with established products from other vendors |

| Technical data | | | | | | Accessories |
|---|------------------------|----------------------|---|----------------------------------|-------------------|-------------|
| Item no. | Model / Lip dimensions | Connection thread |  | Material / Colour | Spare vacuum cup: | |
|  | | | | | | |
| Smooth design with fitting & filter screen | | | | | | |
| 120.020.006._* | SP-F-20 | G1/8-male, M5-female | 2.5 | SI (tr), CR (sw) | 102.020.095._* | |
| 120.030.013._* | SP-F-30 | G1/8-male, M5-female | 3.5 | SI (tr), CR (sw) | 102.030.096._* | |
| 120.040.076._* | SP-F-40 | G1/8-female | 4 | SI (tr), CR (sw) | 102.040.094._* | |
| 120.050.078._* | SP-F-50 | G1/8-female | 6.5 | SI (tr), CR (sw) | 102.050.097._* | |
|  | | | | | | |
| Smooth design with fitting, filter screen & touch valve | | | | | | |
| 121.030.006._* | SP-F-30 | G1/8-male, M5-female | 2.5 | SI (tr), CR (sw) | 102.030.096._* | |
| 121.040.007._* | SP-F-40 | G1/8-female | 4 | SI (tr), CR (sw) | 102.040.094._* | |
| 121.050.008._* | SP-F-50 | G1/8-female | 2.5 | SI (tr), CR (sw) | 102.050.097._* | |
|  | | | | | | |
| With cleats, fitting & filter screen | | | | | | |
| 123.020.003._* | SP-FA-20 | G1/8-male, M5-female | 1 | Tepuflex® (or), SI (tr), CR (sw) | 125.020.004._* | |
| 123.025.010._* | SP-FA-25 | G1/8-male, M5-female | 1 | Tepuflex® (or), SI (tr), CR (sw) | 125.025.007._* | |
| 123.030.019._* | SP-FA-30 | G1/8-male, M5-female | 2 | Tepuflex® (or), SI (tr), CR (sw) | 125.030.010._* | |
| 123.040.028._* | SP-FA-40 | G1/8-female | 2 | Tepuflex® (or), SI (tr), CR (sw) | 125.040.013._* | |
| 123.050.034._* | SP-FA-50 | G1/8-female | 2.5 | Tepuflex® (or), SI (tr), CR (sw) | 125.050.017._* | |
| 152.078.133._* | SP-FA-75 | G1/8-female | 3 | Tepuflex® (or), SI (tr), CR (sw) | 154.078.027._* | |
| 152.078.136._* | SP-FA-75 | G3/8-female | 3 | Tepuflex® (or), SI (tr), CR (sw) | 154.078.027._* | |
| 152.078.139._* | SP-FA-75 | G1/2-female | 3 | Tepuflex® (or), SI (tr), CR (sw) | 154.078.027._* | |
| 152.113.134._* | SP-FA-110 | G3/8-female | 5 | Tepuflex® (or), SI (tr), CR (sw) | 154.113.028._* | |
| 152.113.137._* | SP-FA-110 | G1/2-female | 5 | Tepuflex® (or), SI (tr), CR (sw) | 154.113.028._* | |
| 152.155.135._* | SP-FA-150 | G1/2-female | 5 | Tepuflex® (or), SI (tr), CR (sw) | 154.155.026._* | |
| 152.155.138._* | SP-FA-150 | G3/4-female | 5 | Tepuflex® (or), SI (tr), CR (sw) | 154.155.026._* | |
|  | | | | | | |
| With cleats, fitting, filter screen & touch valve | | | | | | |
| 124.030.002._* | SP-FA-30 | G1/8-male, M5-female | 2 | SI (tr), CR (sw) | 125.030.010._* | |
| 124.040.006._* | SP-FA-40 | G1/8-female | 2 | SI (tr), CR (sw) | 125.040.013._* | |
| 124.050.009._* | SP-FA-50 | G1/8-female | 2.5 | SI (tr), CR (sw) | 125.050.017._* | |

* Material code: CR = 9, SI = 2, SI-LE = 2-LE, Tepuflex® = 17



Series | Flat vacuum cups SF

Flat vacuum cups with fully assembled fitting – SP-F

Flat vacuum cups with fully mounted fitting

Example:

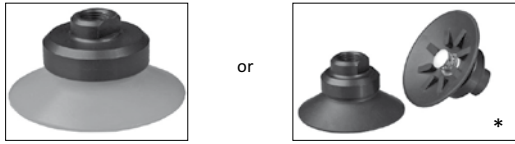

* Version with touch valve available only for flat vacuum cups in smooth design and flat vacuum cups with cleats

- > High process reliability thanks to permanently installed fitting
- > Worn sealing lips can be replaced if necessary

Dimensions

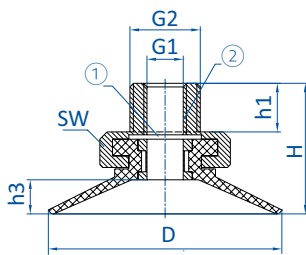

Drawing A

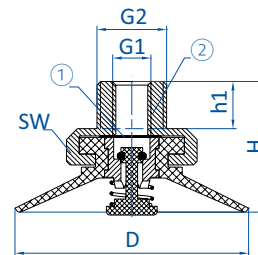

Drawing B

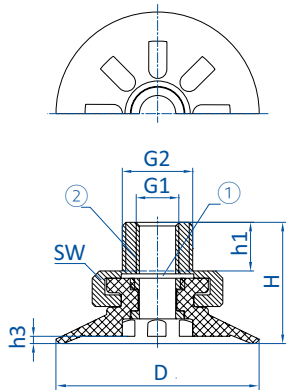

Drawing C

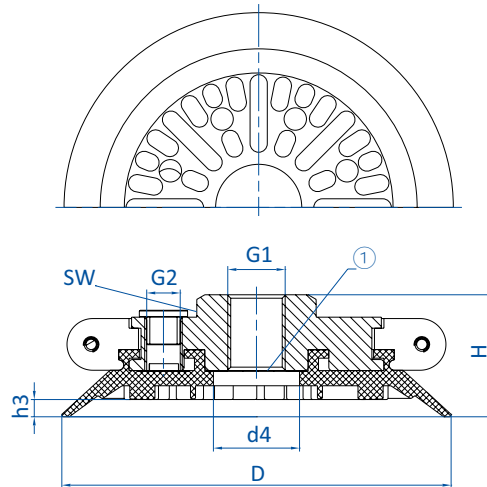

Drawing D

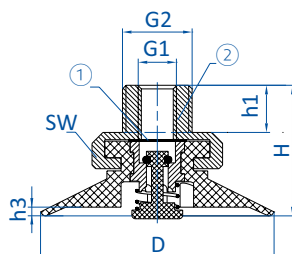

Drawing E

① = Filter screen ② = Aluminum

* Material code: CR = 9, SI = 2, SI-LE = 2-LE, Tepuflex® = 17



| Item no. | Drawing | Ø D [mm] | Ø d4 [mm] | G1 | G2 | H [mm] | h1 [mm] | h3 [mm] | SW |
|--|---------|----------|-----------|------|------|--------|---------|---------|----|
| Smooth design with fitting & filter screen | | | | | | | | | |
| 120.020.006.* | A | 22 | -- | M5 | G1/8 | 15.5 | 6.5 | 3 | 17 |
| 120.030.013.* | A | 32 | -- | M5 | G1/8 | 18 | 6.5 | 4.5 | 17 |
| 120.040.076.* | A | 42 | -- | G1/8 | -- | 22 | -- | 6 | 12 |
| 120.050.078.* | A | 52 | -- | G1/8 | -- | 27 | -- | 8.5 | 12 |
| Smooth design with fitting, filter screen & touch valve | | | | | | | | | |
| 121.030.006.* | B | 32 | -- | M5 | G1/8 | 18 | 6.5 | -- | 17 |
| 121.040.007.* | B | 42 | -- | G1/8 | -- | 22 | -- | -- | 12 |
| 121.050.008.* | B | 52 | -- | G1/8 | -- | 27 | -- | -- | 12 |
| With cleats, fitting & filter screen | | | | | | | | | |
| 123.020.003.* | C | 22 | -- | M5 | G1/8 | 15.5 | 6.5 | 0.9 | 17 |
| 123.025.010.* | C | 28 | -- | M5 | G1/8 | 16.5 | 6.5 | 1 | 17 |
| 123.030.019.* | C | 32 | -- | M5 | G1/8 | 18 | 6.5 | 1.2 | 17 |
| 123.040.028.* | C | 42 | -- | G1/8 | -- | 22 | -- | 2.1 | 12 |
| 123.050.034.* | C | 53 | -- | G1/8 | -- | 26 | -- | 2 | 12 |
| 152.078.133.* | D | 78 | 10 | G1/8 | -- | 26 | -- | 3 | 28 |
| 152.078.136.* | D | 78 | 10 | G3/8 | -- | 26 | -- | 3 | 28 |
| 152.078.139.* | D | 78 | 10 | G1/2 | -- | 26 | -- | 3 | 28 |
| 152.113.134.* | D | 113 | 25 | G3/8 | G1/8 | 35 | -- | 5 | 30 |
| 152.113.137.* | D | 113 | 25 | G1/2 | G1/8 | 35 | -- | 5 | 30 |
| 152.155.135.* | D | 155 | 25 | G1/2 | G1/8 | 38 | -- | 5 | 38 |
| 152.155.138.* | D | 155 | 25 | G3/4 | G1/8 | 38 | -- | 5 | 38 |
| With cleats, fitting, filter screen & touch valve | | | | | | | | | |
| 124.030.002.* | E | 32 | -- | M5 | G1/8 | 18 | -- | 1.2 | 17 |
| 124.040.006.* | E | 42 | -- | G1/8 | -- | 22 | -- | 2.1 | 12 |
| 124.050.009.* | E | 53 | -- | G1/8 | -- | 26 | -- | 2 | 12 |

* Material code: CR = 9, SI = 2, SI-LE = 2-LE, Tepuflex® = 17