

MODULAR RETAINER

ES Retensor Modular DE Mitnehmer Modular
IT Ritenore Modulare PT Retensor Modular FR Retenue Modulée



RM

EJECTION



Patented

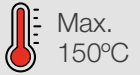

● Cad Insertion Point

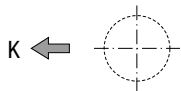
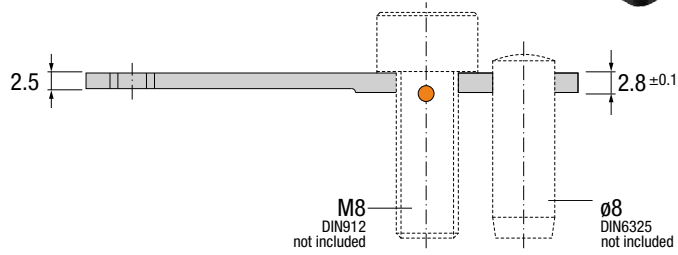
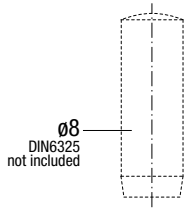

Ref.
RM.651608

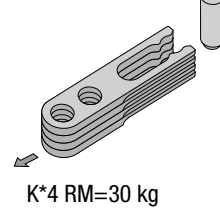
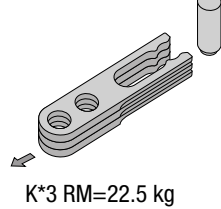
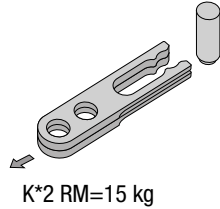
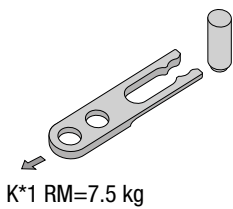
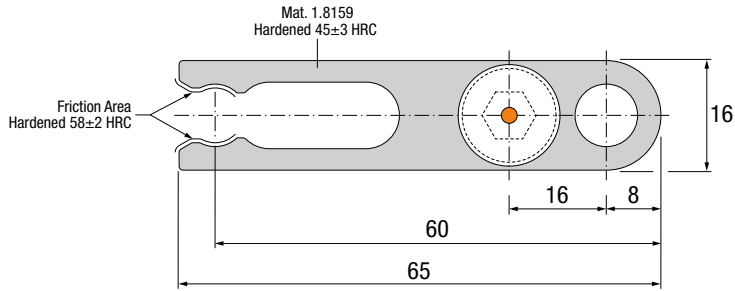

IMPORTANT !
 K=Approximate resistance value that can be obtained by grouping clips.
 K=Valor aproximado de resistencia que se puede obtener agrupando clips.
 K=Zirka Widerstand beim Einbau entsprechend obiger Darstellung.
 K=Valore approssimativo di resistenza che si può ottenere raggruppando più ritenori.
 K=Valor aproximado de resistência que se pode obter agrupando clips.
 K=Valeur approximative que l'on peut obtenir en assemblant les retenues.

Installation Guidelines

Consejos de Instalación · Richtlinien zur Installation · Consigli di Installazione · Instruções de Instalação · Mode d'Installation

